

## Safety Instructions



1, 2, 3, 4, 5, 6, 7, 8, 11, 12,  
15, 16, 17, 18, 19, 20, 21,  
22, 24, 26, 33, 34

Info Hotline



+49 (0) 5041 998 389

Mon.-Do. 7<sup>00</sup> - 20<sup>00</sup>

Fr. 7<sup>00</sup> - 17<sup>00</sup>

Paulmann Licht  
GmbH Quezinger  
Feld 2  
31832 Springe  
Germany

[www.paulmann.com](http://www.paulmann.com)

Art.-Nr.: **666.46**

(+MA 326) PLD 11/16

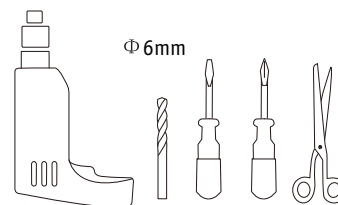
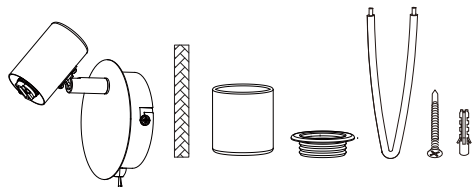

**A**



Safety  
Instructions  
Nr. 4, 5, 6, 7, 8, 12, 19

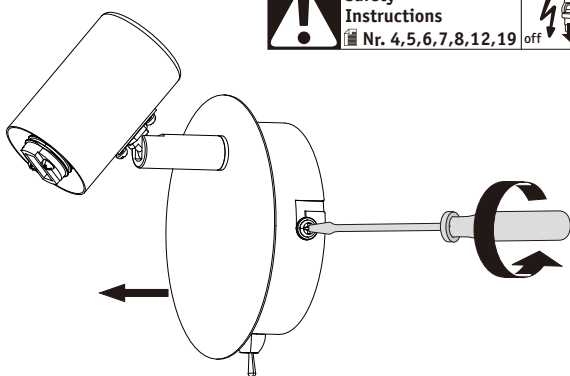

**B**

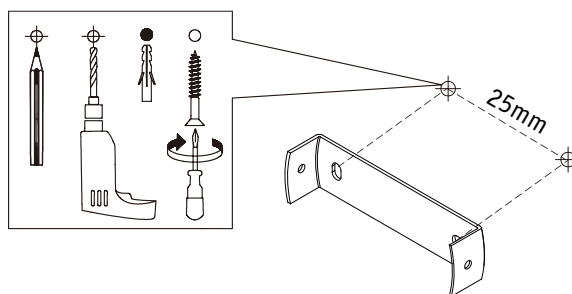

**C**

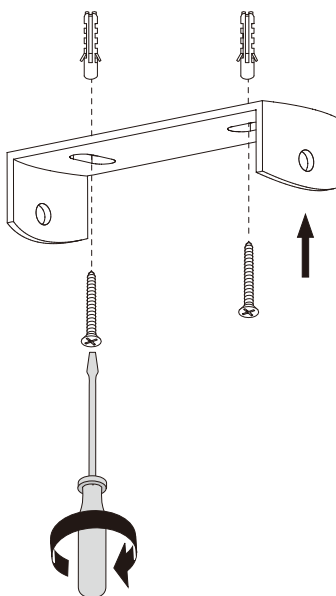

**D**



Safety  
Instructions  
Nr. 3, 11, 28

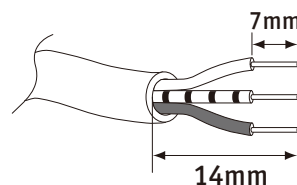

230V

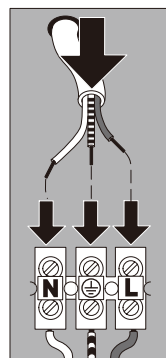

**E**



Safety  
Instructions  
Nr. 17, 18, 20

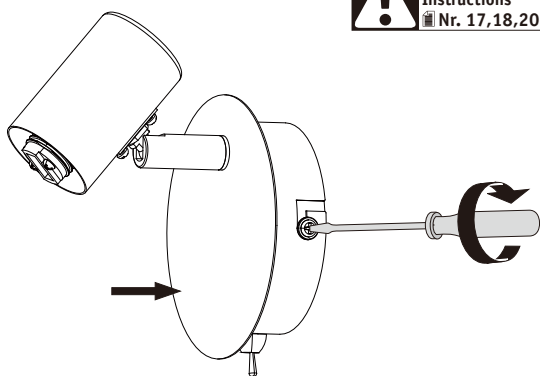

**F**



Safety  
Instructions  
Nr. 15

